

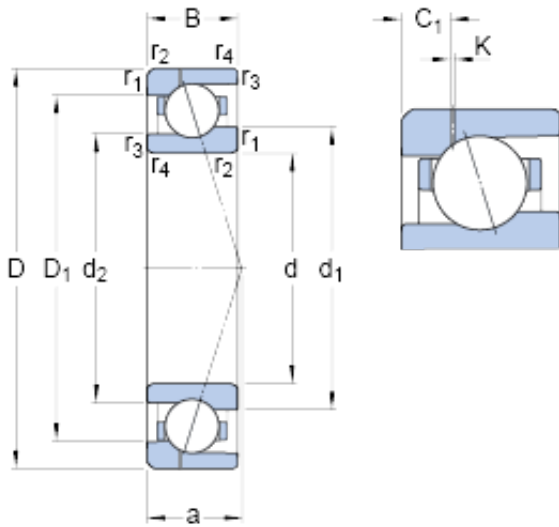

NTN Bearing Rolamentos do Brasil Ltda.



80 mm x 110 mm x 16 mm skf 71916
ACE/P4AH1 Super-precision Angular contact ball bearings

Bearing No. 71916 ACE/P4AH1

71916 ACE/P4AH1 Bearing 2D drawings and 3D CAD models

Size	110x80x16 mm
Bore Diameter	110 mm
Outer Diameter	80 mm
Width	16 mm
d	80 mm
D	110 mm
B	16 mm
d ₁	89.3 mm
d ₂	86.8 mm
D ₁	100.52 mm
K	0.5 mm
C ₁	4.9 mm
r _{1,2} - min.	1 mm
r _{3,4} - min.	0.3 mm
a	32 mm
d _a - min.	84.6 mm
d _b - min.	82 mm
D _a - max.	105.4 mm
D _b - max.	108 mm
r _a - max.	1 mm
r _b - max.	0.3 mm
d _n	91.5 mm
Basic dynamic load rating - C	21.2 kN



NTN Bearing Rolamentos do Brasil Ltda.

Basic static load rating - C_0	17 kN
Fatigue load limit - P_u	0.71 kN
Limiting speed for grease lubrication	14500 r/min
Limiting speed for oil lubrication	22000 mm/min
Ball - D_w	9.525 mm
Ball - z	24
G_{ref}	4.8 cm ³
Calculation factor - e	0.68
Calculation factor - Y_2	0.87
Calculation factor - Y_0	0.38
Calculation factor - X_2	0.41
Calculation factor - Y_1	0.92
Calculation factor - Y_2	1.41
Calculation factor - Y_0	0.76
Calculation factor - X_2	0.67
Preload class A - G_A	195 N
Preload class B - G_B	590 N
Preload class C - G_C	1170 N
Calculation factor - f	1.19
Calculation factor - f_1	0.99
Calculation factor - f_{2A}	1
Calculation factor - f_{2B}	1.04
Calculation factor - f_{2C}	1.07
Calculation factor - f_{HC}	1
Preload class A	141 N/micron
Preload class B	214 N/micron
Preload class C	281 N/micron
d_1	89.3 mm



NTN Bearing Rolamentos do Brasil Ltda.

d_2	86.8 mm
D_1	100.52 mm
C_1	4.9 mm
$r_{1,2}$ min.	1 mm
$r_{3,4}$ min.	0.3 mm
d_a min.	84.6 mm
d_b min.	82 mm
D_a max.	105.4 mm
D_b max.	108 mm
r_a max.	1 mm
r_b max.	0.3 mm
d_n	91.5 mm
Basic dynamic load rating C	21.2 kN
Basic static load rating C_0	17 kN
Fatigue load limit P_u	0.71 kN
Attainable speed for grease lubrication	14500 r/min
Attainable speed for oil-air lubrication	22000 r/min
Ball diameter D_w	9.525 mm
Number of balls z	24
Reference grease quantity G_{ref}	4.8 cm ³
Preload class A G_A	195 N
Static axial stiffness, preload class A	141 N/ μ m
Preload class B G_B	590 N
Static axial stiffness, preload class B	214 N/ μ m
Preload class C G_C	1170 N
Static axial stiffness, preload class C	281 N/ μ m
Calculation factor f	1.19
Calculation factor f_1	0.99



NTN Bearing Rolamentos do Brasil Ltda.

Calculation factor f_{2A}	1
Calculation factor f_{2B}	1.04
Calculation factor f_{2C}	1.07
Calculation factor f_{HC}	1
Calculation factor e	0.68
Calculation factor (single, tandem) Y_2	0.87
Calculation factor (single, tandem) Y_0	0.38
Calculation factor (single, tandem) X_2	0.41
Calculation factor (back-to-back, face-to-face) Y_1	0.92
Calculation factor (back-to-back, face-to-face) Y_2	1.41
Calculation factor (back-to-back, face-to-face) Y_0	0.76
Calculation factor (back-to-back, face-to-face) X_2	0.67
Mass bearing	0.36 kg