

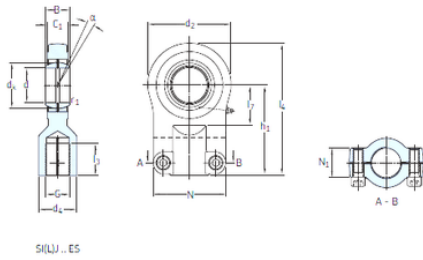

NTN Bearing Rolamentos do Brasil Ltda.



skf SIJ 100 ES Spherical plain bearings and rod ends with a female thread

Bearing No. SIJ 100 ES

SIJ 100 ES Bearing 2D drawings and 3D CAD models

Bore Diameter	100 mm
d	100 mm
d2 max.	240 mm
d4 max.	110 mm
dk	130 mm
h1	240 mm
l3 min.	86 mm
l4 max.	360 mm
l7 min.	116 mm
r1 min.	1 mm
B	70 mm
C1 max	57 mm
N max	190 mm
N1 max	57 mm
Thread (G)	M 64x3 Tolerance 6H
Angle	3 °
Weight	29,5 Kg
Basic dynamic load rating (C)	610 kN
d ₂ max.	240 mm
G	M 64x3
C ₁ max.	57 mm
h ₁	240 mm
	7 °
d _k	130 mm
d ₄ max.	112 mm



NTN Bearing Rolamentos do Brasil Ltda.

l_3 min.	86 mm
l_4 max.	360 mm
l_7 min.	116 mm
N max.	191 mm
N_1 max.	57 mm
r_1 min.	1 mm
Size bolt with internal hexagon	M 24
Tightening torque bolt with internal hexagon	530 N · m
Basic dynamic load rating C	610 kN
Basic static load rating C_0	780 kN
Specific dynamic load factor K	100 N/mm ²
Material constant K_M	330
Mass rod end	29.5 kg