

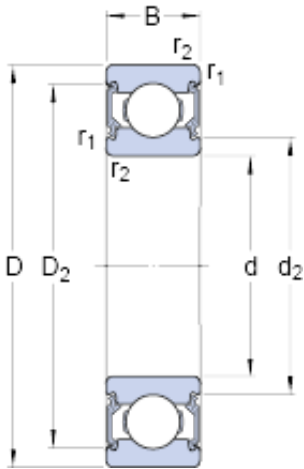

NTN Bearing Rolamentos do Brasil Ltda.



20 mm x 42 mm x 12 mm skf 6004-2RSH Deep groove ball bearings

Bearing No. 6004-2RSH

6004-2RSH Bearing 2D drawings and 3D CAD models

Size	42x20x12 mm
Bore Diameter	42 mm
Outer Diameter	20 mm
Width	12 mm
d	20 mm
D	42 mm
B	12 mm
d ₂	24.65 mm
D ₂	37.19 mm
r _{1,2} - min.	0.6 mm
d _a - min.	23.2 mm
d _a - max.	24.5 mm
D _a - max.	38.8 mm
r _a - max.	0.6 mm
Basic dynamic load rating - C	10 kN
Basic static load rating - C ₀	5 kN
Fatigue load limit - P _u	0.212 kN
Limiting speed	11000 r/min
Calculation factor - k _r	0.025
Calculation factor - f ₀	14
Category	Single Row Ball Bearings
Inventory	22.0
Manufacturer Name	SKF
Minimum Buy Quantity	N/A



NTN Bearing Rolamentos do Brasil Ltda.

Weight / Kilogram	0.075
EAN	7316571815732
Product Group	B00308
Enclosure	2 Seals
Precision Class	ABEC 1 ISO P0
Maximum Capacity / Filling Slot	No
Rolling Element	Ball Bearing
Snap Ring	No
Internal Special Features	No
Cage Material	Steel
Enclosure Type	Contact Seal
Internal Clearance	C0-Medium
Inch - Metric	Metric
Long Description	20MM Bore; 42MM Outside Diameter; 12MM Outer Race Width; 2 Seals; Ball Bearing; ABEC 1 ISO P0; No Filling Slot; No Snap Ring; No Internal Special Features; C0-Medium Internal Clearance; Steel Cage;
Other Features	Deep Groove NBR Seal
Category	Single Row Ball Bearing
UNSPSC	31171504
Harmonized Tariff Code	8482.10.50.68
Noun	Bearing
Keyword String	Ball
Manufacturer URL	http://www.skf.com
Manufacturer Item Number	6004-2RSH
Weight / LBS	0.165
Outer Race Width	0.472 Inch 12 Millimeter
Outside Diameter	1.654 Inch 42 Millimeter
Bore	0.787 Inch 20 Millimeter



NTN Bearing Rolamentos do Brasil Ltda.

Inner Race Width	0 Inch 0 Millimeter
bore diameter:	20 mm
static load capacity:	5 kN
outside diameter:	42 mm
precision rating:	Not Rated
overall width:	12 mm
finish/coating:	Uncoated
bore type:	Round
cage material:	Steel
closure type:	Double Sealed
outer ring width:	12 mm
row type & fill slot:	Single Row Non-Fill Slot
fillet radius:	0.6 mm
internal clearance:	C0
maximum rpm:	11000 RPM
operating temperature range:	-40 to +210 ° F
series:	60
dynamic load capacity:	9.95 kN
d_2	24.65 mm
D_2	37.19 mm
$r_{1,2}$ min.	0.6 mm
d_a min.	23.2 mm
d_a max.	24.5 mm
D_a max.	38.8 mm
r_a max.	0.6 mm
Basic dynamic load rating C	9.95 kN
Basic static load rating C_0	5 kN
Fatigue load limit P_u	0.212 kN
Calculation factor k_r	0.025
Calculation factor f_0	14
Mass bearing	0.07 kg